



ANLY TIMER

AH2 MULTI-RANGE ANALOGUE TIMER



CHARACTERISTIC :

- Customized CMOS IC for low power consumption, high operation stability and extreme timing accuracy
- Large transparent knob for easy adjustment and monitoring
- 15 different time ranges available, from 0.1sec to 24hour
- 5(A, B, C, D, E) timing series available*
- Each timing series has 4 time ranges, selectable via DIP switch*
- CE certified

Note: "*" indicates applicable to AH2 multi-range series only

SPECIFICATION :

Operating voltage	DC(V): 12, 24 AC(V): 12, 24, 110, 220, 240
Allowable operating voltage range	85~110% of rated operating voltage
Rated frequency	50 / 60 Hz
Contact rating	250VAC 5A (resistive load)
Reset time	MAX 0.1S
Power consumption	Approx. 3VA
Life	Mechanical: 5,000,000 times Electrical: 100,000 times
Ambient temperature	-10 ~ +50°C (without condensation & freezing)
Ambient humidity	MAX 85% RH (without condensation)
Altitude	MAX 2000m
Weight	Approx. 200g

TYPE SELECTION :

Model	Single Range Variable			Multi-Range Variable		
Output contact	1C	2C Delayed	2C Inst.+Delayed	A / B Mode		
Type	AH2-N1	AH2-N2	AH2-N	AH2-NA / YA	AH2-NB / YB	AH2-NC / YC
Time range	1, 3, 6, 10, 30 or 60S 3, 6, 10, 30 or 60M, 3, 6, 10 or 24H			1S/ 10S/ 1M/ 10M	3S/ 30S/ 3M/ 30M	6S/ 60S/ 6M/ 60M
Type	AH2-Y1	AH2-Y2	AH2-Y	AH2-ND / YD	AH2-NE / YE	
Time range	1, 3, 6, 10, 30 or 60S 3, 6, 10, 30 or 60M, 3, 6, 10 or 24H			1M/ 10M/ 1H/ 10H	3M/ 30M/ 3H/ 30H	

CONNECTION :

1C

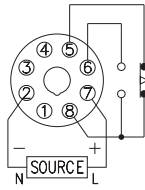

2C Delayed, A Mode

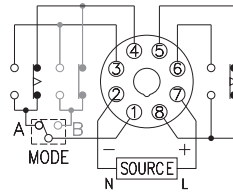

2C Inst.+Delayed, B Mode

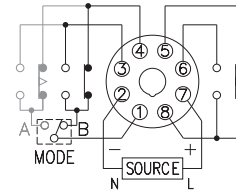

TIMING CHART :

1C

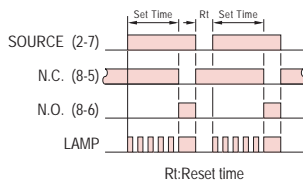

2C Delayed, A Mode

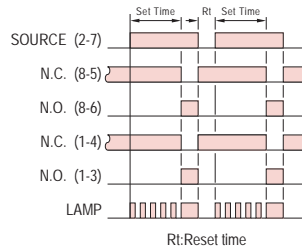

2C Inst.+Delayed, B Mode

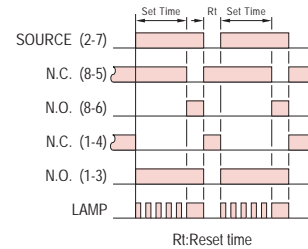

DIMENSIONS : (mm)

N type(Surface Mounting): Using 8PFA Socket

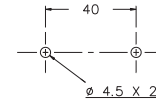
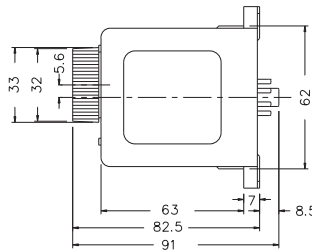
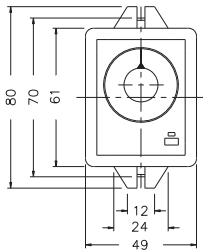

Y type(Flush Mounting): Using US-08 Socket or P3G-08 Socket

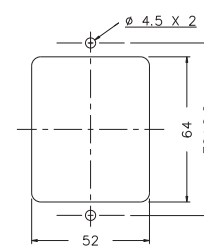
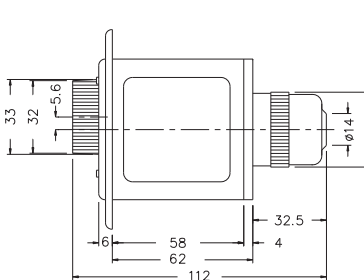
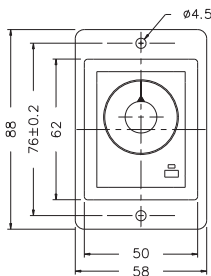

Tolerance:±0.1

ANLY ELECTRONICS CO., LTD.

<http://www.anly.com.tw>

TAIWAN MAIN OFFICE : ANLY ELECTRONICS CO., LTD.

No.19, Lane 202, Fushou St., Xinzhuang Dist., New Taipei City 242, Taiwan
TEL: +886-2-2996-3202 FAX: +886-2-2996-2017

HONG KONG OFFICE : ANLY ELECTRONICS (HK) LTD.

Flat K, 13/F, Edward Mansion, 141 Prince Edward Road W., Kowloon, Hong Kong
TEL: +852-2397-2505 FAX: +852-2397-6080

CHINA OFFICE : ANLY TECHNOLOGY (WUXI) CO., LTD.

2F, Building A, Plot 1, No. 28, Zhanhong Rd., Xinwu Dist., Wuxi, Jiangsu, P.R.China
TEL: +86-510-85304801-3

MALAYSIA OFFICE : JUSTY ELECTRONICS (M) SDN. BHD.

No.1, Jalan 6/89B, Kawasan Perindustrian Trisegi, Batu 3 1/2 Off Jalan Sungei Besi, 57100 Kuala Lumpur, Malaysia
TEL: +60-3-7983-5758 FAX: +60-3-7981-5052

INDONESIA OFFICE : PT. ANLY ELECTRONICS INDONESIA

Jl. Pangeran Jayakarta 117/B9, Jakarta Pusat, 10730 Indonesia
TEL: +62-21-624-8436 FAX: +62-21-626-1228

NO. AH2-W-A