



# ANLY CONTROLLER

## EP4-3 DIGITAL CURRENT RELAY



### CHARACTERISTIC :

- Digital current monitoring and fault detection
- Definite or Time-inverse monitoring
- 3-phase or single phase current
- Over Current:
  - Definite 0.5-80A, 0.2~30 Sec,
  - Time Inverse 0.5~60A, Level 1~30
- Under Current: response time 0.5~30 Sec
- Phase Loss: over 85%, response time 0.5~5 Sec
- Phase Reversal: response time 0.1Sec
- Stall: 2X~8X,  
response time = Delay time + 0.1Sec
- Lock: 1.5X~8X, response time 0.2~10Sec
- Current Balance: range 10~50%  
response time 1~10 Sec
- Optional external CT
- Operating time can be displayed or set
- Non-resettable total monitoring time
- Last 3 errores are recorded
- Faule reset via power reset, manual and auto
- Auto reset attempt within 30 min can be capped

### SPECIFICATION :

Operating voltage	AC/DC(V): 100 - 240
Allowable operating voltage range	85 ~ 110% of rated operating voltage
Rated frequency	50 / 60 Hz
Monitoring range	Definite 0.5~80A, Inverse 0.5~60A
Contact rating	250VAC 5A (resistive load)
Power consumption	Approx. 6.2VA
Life	Mechanical: 5,000,000 times Electrical: 100,000 times
Ambient temperature	-10 ~ +50°C (without condensation & freezing)
Ambient humidity	MAX 85% RH (without condensation)
Altitude	MAX 2000m
Weight	Approx.138g , CT:Approx.223g

## CONNECTION :

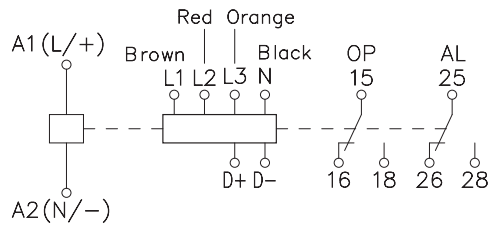

## CONNECTION :

3-phase

Single phase

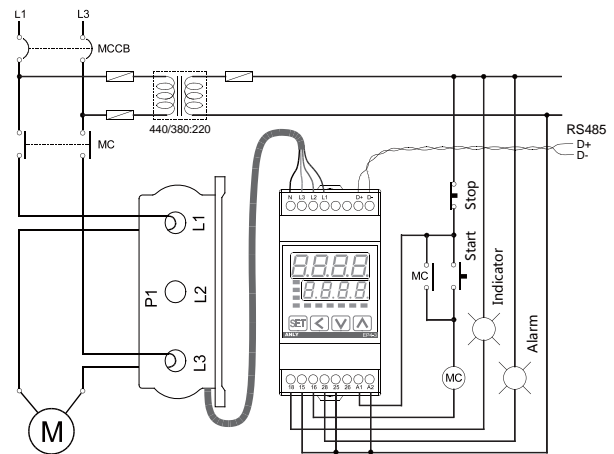
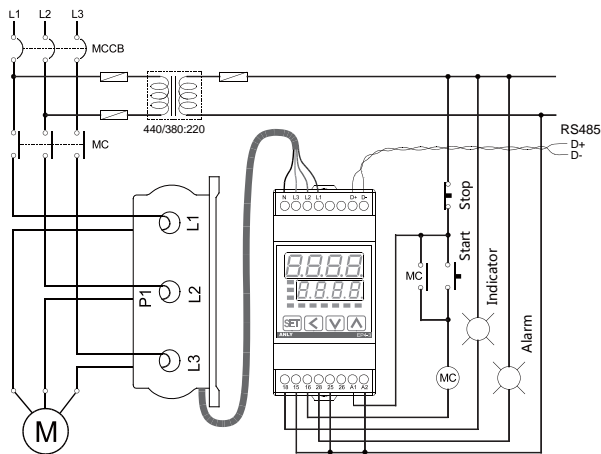

## DIMENSIONS : (mm)

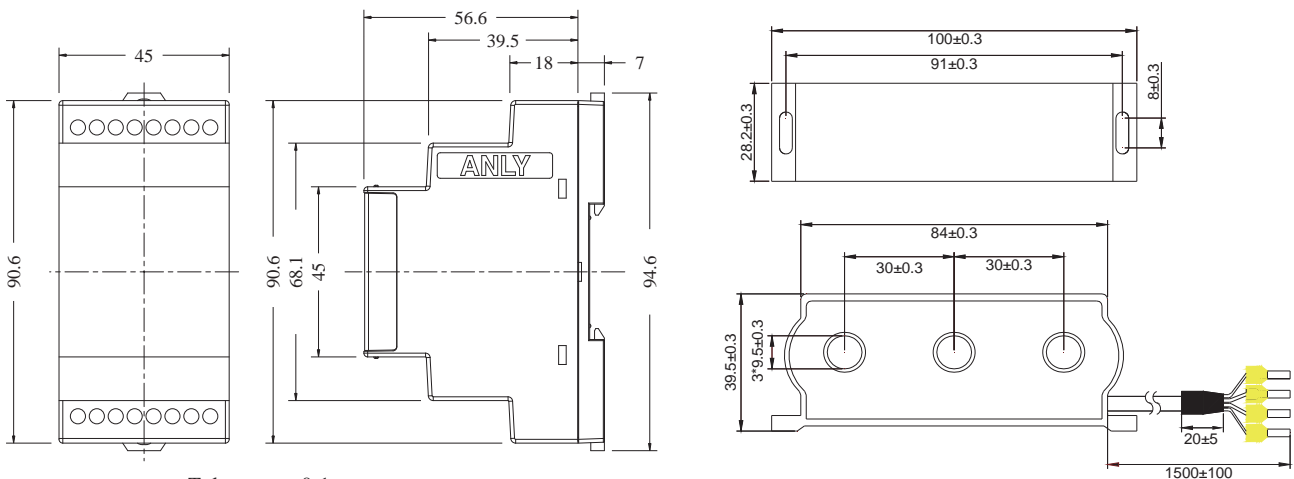

Tolerance:±0.1

**ANLY ELECTRONICS CO., LTD.**

<http://www.anly.com.tw>

**TAIWAN MAIN OFFICE : ANLY ELECTRONICS CO., LTD.**

No.19, Lane 202, Fushou St., Xinzhuang Dist., New Taipei City 242, Taiwan  
TEL: +886-2-2996-3202 FAX: +886-2-2996-2017

**HONG KONG OFFICE : ANLY ELECTRONICS (HK) LTD.**

Flat K, 13/F, Edward Mansion, 141 Prince Edward Road W., Kowloon, Hong Kong  
TEL: +852-2397-2505 FAX: +852-2397-6080

**CHINA OFFICE : ANLY TECHNOLOGY (WUXI) CO., LTD.**

2F, Building A, Plot 1, No. 28, Zhanhong Rd., Xinwu Dist., Wuxi, Jiangsu, P.R.China  
TEL: +86-510-85304801-3

**MALAYSIA OFFICE : JUSTY ELECTRONICS (M) SDN. BHD.**

No.1, Jalan 6/89B, Kawasan Perindustrian Trisegi, Batu 3 1/2 Off Jalan Sungei Besi, 57100 Kuala Lumpur, Malaysia  
TEL: +60-3-7983-5758 FAX: +60-3-7981-5052

**INDONESIA OFFICE : PT. ANLY ELECTRONICS INDONESIA**

Jl. Pangeran Jayakarta 117/B9, Jakarta Pusat, 10730 Indonesia  
TEL: +62-21-624-8436 FAX: +62-21-626-1228

NO. EP43-W-A